

LAMURA[®]

SURFACES FOR LIFE

Installation and
maintenance guidelines

IMPORTANT: Please follow these instructions carefully

Installation and maintenance guidelines

- These products have a PUR underedge seal and meet FIRA Gold product certification requirement inc.: workmanship, finish, adhesion, environmental, substrate, laminate performance and resistance to immersion in water.
- Darker, smoother laminates although manufactured to the same standards (EN438) tend to show visible scratches and abrasions more than lighter coloured laminates.
- The majority of Lamura worktops, breakfast bars and island units are supplied with a 50mm excess length (material trim allowance on length).
- All exposed edges of chipboard should be sealed with a waterproof sealant by the installer (i.e. silicone).

Cleaning

For general cleaning gently wipe the surface using either a damp cloth or sponge with a mild detergent or non-abrasive cleaner diluted in warm water. It is important to avoid using abrasive scouring powders, creams or polishes. It is always advisable to wipe off any spillages immediately. Persistent stains should be treated with white spirit. Whilst the surface will resist most household foodstuffs, including coffee and red wine, certain products such as shoe polish, dyes and nail varnish will stain. Quartz worktops need extra care to maintain the surface finish. See the adjacent 'Cleaning Stains' for guidance.

Heat Resistance

Never place hot pans, dishes or objects from the oven or hob directly in contact with the laminate surface, this may lead to blistering or cracking. Care should also be taken with hot irons and cigarettes.

Impact Resistance

The laminate surface is resistant to impact and has been tested to EN 438 part 2. Any objects with sharp edges may cause surface damage.



Cleaning Stains

General Household Products	Dry Cloth / Duster	Damp Cloth	Warm water & Detergents	Non-abrasive cleaner	White Spirit	Nail Polish Remover
Dust/Light Dirt	✓					
Soap Residue		✓	✓	✓		
Shoe Polish					✓	
Biro or Pen			✓	✓		
Wax Crayon					✓	
Bleach		✓	✓	✓		
Lipstick			✓	✓		
Nail Varnish						✓
Dyes - washable			✓	✓		
Dyes - permanent					✓	✓
Food Stuffs						
Tea		✓	✓	✓		
Milk		✓	✓	✓		
Fruit Juice		✓	✓	✓		
Red Wine		✓	✓	✓		
Vinegar		✓	✓	✓		
Lemon Juice		✓	✓	✓		
Vegetable Oil		✓	✓	✓		
Beetroot		✓	✓	✓		
Curry		✓	✓	✓		
Others						
Nicotine			✓	✓		
Paint - water based			✓	✓		
Paint - solvent based					✓	
Blood			✓	✓		
Fingermarks		✓	✓	✓		

Please thoroughly inspect your new Lamura worktop, island unit, breakfast bar and other components for colour matching, damage and imperfections - before installation.

General

It is important to inspect your new Lamura laminate surface for any damage or defects before any work commences, as installed worktops, island units, breakfast bars, upstands and splashbacks will be seen as having been accepted and no liability will be accepted for its repair and/or replacement.

Preparation

If not required for immediate installation your worksurface should be stored flat, on batons, away from excess temperature, humidity or standing water. Your Lamura laminate surface should be sufficiently supported during the cutting, drilling and sawing stages of installation. It is essential that all kitchen cabinet products have been installed correctly using a spirit level before installing your worktop and breakfast bar.

Marking can be done with a soft pencil either on the face of the worktop if using a handsaw or on the underside if using a power saw.

For your safety please ensure all cutting/drilling tools are sharp and safety goggles are used at all times whenever cutting into your Lamura laminate surface.

Installing your Lamura Laminate Surfaces

CUTTING - Remember, before cutting double-check your measurements.

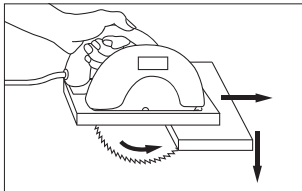

For best results when using an electric circular or jig saw, cut the Lamura laminate surface face down so that the saw teeth cut into the laminate surface starting from the profiled front edge.

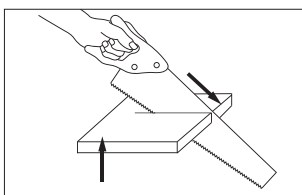

If using a hand saw, (10 to 12 teeth per 25mm) cut the Lamura laminate surface face up. Always start from the profiled front edge and keep the saw at a low angle.

Once your laminate surfaces have been cut the edge can be trimmed and cleaned using a portable hand router to achieve a perfect chip-free cut. This is important particularly if a joint or edging is required.

Worktop Joints

Ensure the two edges to be joined are clean and then apply a continuous bead of sealant down the entire length of the joint and down the front edge. Draw the worktops together with 3 tension bolts, tightening the bolts until the joint is tight allowing excess sealant to form over the joint.

Wipe off all excess sealant with a clean damp cloth.

Please note: it is important to avoid positioning joints close to cut-outs.

Cut-Outs for Hobs and Sinks

All cut-outs should be carefully measured and clearly marked. Working from the decorative face drill through all the corners using a 12mm drill bit. This allows access for the jig saw blade when cutting around the cut-out and eliminates sharp internal corners that can lead to cracks forming in the laminate surface. It is recommended to leave at least 250mm between cut-outs and from the cut out to the side edge of your worktop. A minimum of 50mm is recommended from the edge of the cut-out to the front and back edges of the worktop. After the cut has been made check the hob or sink for size.

Best Practice Advice: To ensure longevity of your purchase it is advisable to further protect hob cut out edges with aluminium tape to dissipate the heat and moisture from affecting the higher risk areas after installation.

We also recommend to apply 2 coats of varnish to the underside of your worktop, 50mm wide around all underside edges.

Note: Regarding adhesives, sealants, cleaning fluids etc, always follow the instructions on the label.

Product Guarantee

This product has been manufactured to demanding high quality standards and should last many years provided that the laminate surfaces are installed and used in accordance with these instructions.

Typically manufacturing defects are visible on inspection or manifest during/soon after installation. Where a Lamura laminate surface can be shown to have failed by reason of manufacturing defect (subject to wear and tear), we will always consider each claim within its own merit in conjunction with your statutory rights.

Quartz laminate surfaces are not included in this guarantee due to their surface performance characteristics.

Laminates are produced to a predetermined colour tolerance, however slight variations may occur. All surfaces should be thoroughly checked for colour match prior to cutting or installation. Quartz laminate surfaces are more prone to scratching than textures and therefore require extra care and attention during fabrication, installation and use.

The manufacturer reserves the right to determine what remedy is required - repair and/or replacement of worktops.

The manufacturer reserves the right to request proof of date and place of purchase to support any submitted claim.



LAMURA[®]
SURFACES FOR LIFE

Installation and
maintenance guidelines

IMPORTANT: Please follow these instructions carefully